

## CRUSH CELL

to test crush resistance of proppants used in hydraulic fracturing and gravel-packing operations according to ISO13503-2, Fig.7 and API PR-56.

<b>Item no.:</b>	<b>THS947</b>
Max. load:	100 kN
Material:	Steel, nickel-plated, hardened
Temperature range:	-70°C ... +180°C Further temperature ranges on request
Weight:	4.4 kg
Scope of supply:	1 fixture incl. cell and piston. Top and bottom compression platens must be ordered separately

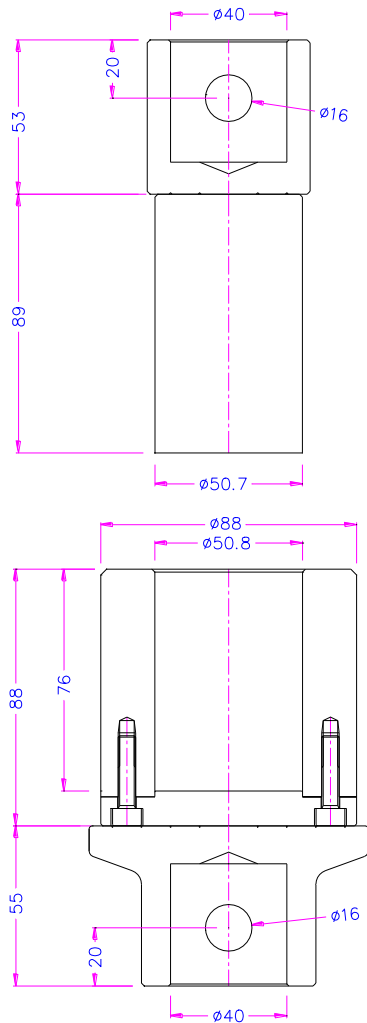

### Recommendation for lower and upper compression platens:

<b>Item no.:</b>	<b>TH23-56-St</b> (upper platen) 50 mm Ø <b>TH23-96-St</b> (lower platen) 96 mm Ø
Coupling:	Af40. Further couplings on request
Material:	Hardened steel, 58 HRC, nickel-plated

